

**WARRANTY 3 YEARS**  
PARTS & LABOUR



**Turbo air**

**NSW & VIC Rebate Eligible**

## BACK BAR

Fridge  
TBB-2SGD

### FEATURES / BENEFITS

#### ■ EFFICIENT REFRIGERATION SYSTEM

Turbo Air's refrigerators are designed with oversized and balance refrigeration systems. These include efficient evaporators and condensers for faster cooling and greater efficiency.

#### ■ FORCED AIR COOLING SYSTEM

Fast cooling and balanced temperature throughout the cabinet.

#### ■ STAINLESS STEEL COUNTERTOP AND INTERIOR

The exterior of cabinet is constructed with heavy gauge reinforce stainless steel countertop and wear-resistant black vinyl coated galvanized steel. Interior is stainless steel floor and door liners w white painted galvanized steel inside walls. Turbo Air Back Bar m guarantees utmost in cleanliness and long product life. It also can add a touch of style to the most refined setting.

#### ■ LED INTERIOR LIGHTING FOR ALL MODELS

Bright LED interior lighting is specifically designed for perfect visi throughout the interior.

#### ■ HIGH DENSITY POLYURETHANE INSULATION

The entire cabinet structure is foamed-in-place using high density, CFC free polyurethane insulation.

#### ■ ADJUSTABLE, HEAVY DUTY, PE (POLYETHYLENE) COATED WIRE SHELVES

#### ■ ERGONOMICALLY DESIGNED DOORS

Customers' fatigue fades away with easy grip handles and doors that open effortlessly. These features along with self-closing doors make this the ultimate choice in customer convenience.

#### ■ SIDE MOUNT COMPRESSOR UNIT

By positioning the compressor on the side of the unit, refrigerators can now be serviced without being moved.



Easy to Clean Air Filter  
Front Access

#### Optional features

- 125mm castors fitte
- 180mm, 105mm, 80mm castors optiona
- Adjustable legs 100-155mm, 70-90m

REFRIGERATOR MANUFACTURER  
**Turbo air**

■ **WARRANTY: 3 Year Parts and Labour Warranty**

# BACK BAR

## Fridge TBB-2SGD

Model	TBB-2SGD
Refrigerant	R-134a
COMP (HP)	1/5HP
POWER INPUT(W)	288W
Energy consumption	
AMPS(A)	
Capacity	580
Product Dimension W	1494
Product Dimension D	692
Product Dimension H	1066
Weight	140
Stainless steel	EGI (BLACK)
Features	SCC
Max GN Pan depth	
GN Pan	
Door lock	Yes
Adjustable Shelves	6
LED light	yes
Temperature range	0~10°C
Ambient temperature	
Drainage / Forced Evaporation	Yes
Temperature control	Digital control
Cooling type	FAN COOLING
Glass Type (Low-e / Heater / How many layer of the glass)	Double Pane Glass Door with Low-E glass

Design and specifications subject to change without notice.  
Actual Shipping weight may differ due to extra packing materials for product protection.

- DOOR LOCKS STANDARD
- SELF-CONTAINED SYSTEM
- 4" SWIVEL CASTERS STANDARD

**WARRANTY 3 YEARS**  
PARTS & LABOUR



### PLAN VIEW

(unit : mm)

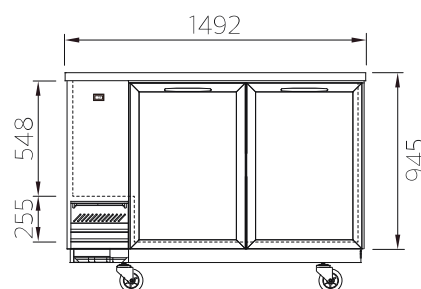

FRONT VIEW

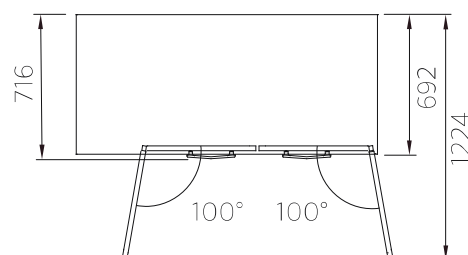

TOP VIEW

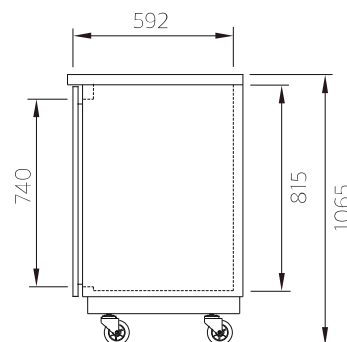

SIDE VIEW

### AUSTRALIA BRANCH

TURBO AIR PTY LTD  
[www.turboairinc.com.au](http://www.turboairinc.com.au)  
 1st Floor, Building E  
 10 Highgate St, Auburn  
 NSW 2144 Australia  
 T. 02 9737 9881

**Turbo air**

email : TA.admin@turboairinc.com.au